

HANECO LIGHTING LED INSTALLATION GUIDE

LED YOUR FUTURE

Haneco Lighting LED Downlights require clearance around the heat sink including thermal insulation and building structural components to be at a minimum of 25mm. This clearance is based on a maximum ambient temperature of 70 °c. The electronic LED driver must be located at least 50mm away from the heat sink in a well ventilated area.

DO NOT COVER



Insulation or combustible material must not come in contact with the luminaire or LED unit.

*Installation Instructions:

1. Take LED fitting out of the box.
2. Cut a hole as per instruction below.
3. Put the plug into the socket.
4. Insert LED Downlight into the pre-cut hole while gently releasing mounting springs.

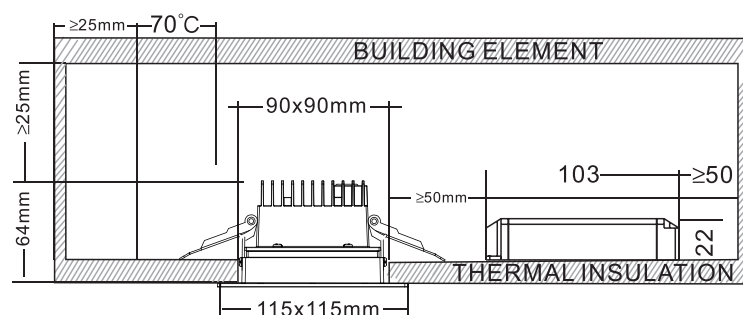

12W

SMD

DIM

IP54

240V

-20°
~ 45°



Alum.

350mA

31VDC

Installation of the product is to be completed by a licensed electrician, in accordance with these instructions and relevant Australia standards/ local regulations.

PRODUCT CODE:AURORASQ115

HANECO
LIGHTING



For more information
1300 001 LED
www.haneco.com.au



Lighting Council
AUSTRALIA
MEMBER 2015