

HANECO LED BATTEN INSTALLATION GUIDE

DURA^{G2}

Thanks for choosing our DURA^{G2} weatherproof batten products.
We strongly recommend that you read this manual carefully before installation.



WARNING

- The batten must be installed by professional electrician.
- Switch power off when wiring the LED batten.
- Ensure product is installed in a well ventilated area.
- Ensure input voltage conforms to the voltage range of product.
- Ensure wires are securely connected.
- Before switching on, ensure that all the wiring is correct.
- The warranty is void if product is not installed according to the instructions



**EMERGENCY
MODEL**

Emergency lamps need to charge for more than 24 hours to meet the full emergency duration. To ensure proper use of the lamps, please carefully read the full instruction guide.

Installation Requirements

- This equipment must be installed and serviced only by a licensed and qualified electricians.
- All wiring and installation must comply with local and national wiring regulations, such as AS/NZS 3000 Electrical Standards.
- Before installation, check the product for any damage incurred during transport. Do not install or operate the product if it appears damaged. If damaged, return the complete product to the place of purchase for inspection, repair, or replacement.
- Avoid pulling or stressing any electrical wires during unpacking, as this may damage the connections.
- Always isolate the electrical supply before carrying out any work on this equipment.

Product Specifications

Product code	DURA06-G2	DURA06-EM-G2	DURA12-G2	DURA12-EM-G2
Power*	10/13/15/18W	10/13/15/18W	18/24/30/36W	18/24/30/36W
CCT	4000/4500/5000K			
CRI	>80			
IP Rating	IP65			
IK Rating	IK08			
Projected Lifespan*	>102,000hrs, @ 40°C L70			
Flicker-free	YES			
Nominal Voltage & Frequency	220~240V, 50/60Hz			
Surge Protection Rating	L-N: 1KV L/N-GND: 2KV			
Inrush Current	12.8A	12.8A	12.9A	12.9A
Rated Operating Ambient Temperature	-20°C to 40°C	0°C to 40°C	-20°C to 40°C	0°C to 40°C
Electrical Connection	PA12			
Fix Hole Centre	340mm	340mm	800mm	800mm
Warranty	5 years			

*Nominal Wattage. Plus 2W while battery recharge for emergency models

Line Diagram and Product Dimensions

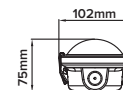
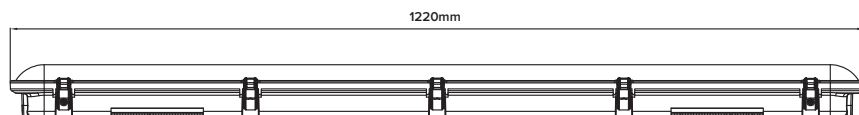
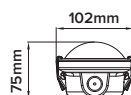
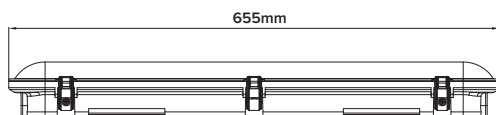

HANECO LED BATTEN INSTALLATION GUIDE

DURA^{G2}

Thanks for choosing our DURA^{G2} weatherproof batten products.
We strongly recommend that you read this manual carefully before installation.

Installation Instructions

In the package:



You will need:

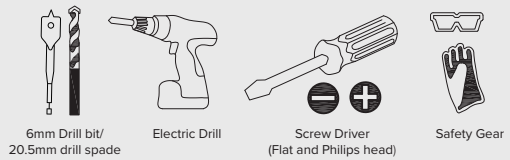

1.

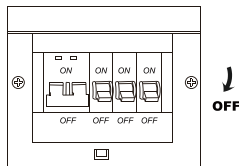

Switch off the power.

2.

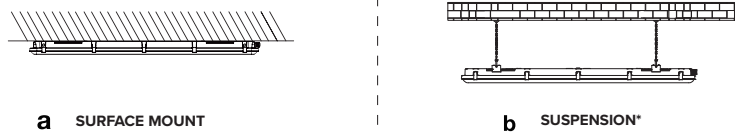

Follow the installation instruction based on the desirable mounting method.

*Suspension kit not included, available as accessory for separate purchase.

3a.

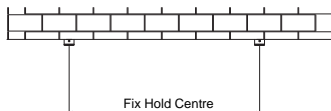

Measure and mark the bracket positions on the ceiling according to the "fixing hole centre" dimensions specified for each model.

4a.

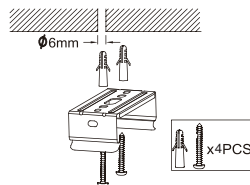

Drill Ø6mm holes into the ceiling, insert the fixing plugs, and securely attach the bracket using the provided screws.

5a.

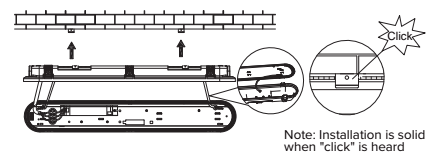

Align the lamp with the stainless steel brackets and press it firmly into place until you hear a "click," indicating that the fixture is securely mounted.

3b.

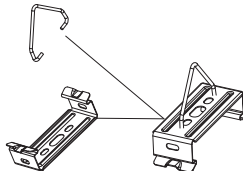

Attach the hook to the two mounting bracket plates.

4b.

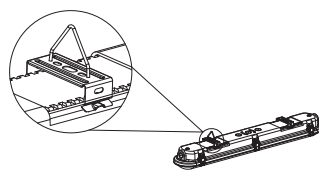

Attach the brackets to the designated mounting points on the batten.

5b.

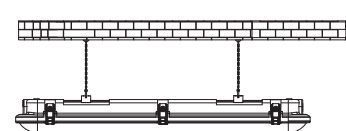

Secure the light fixture to the ceiling with two suspension ropes. (refer to the installation instruction of the suspension kit.)

6.

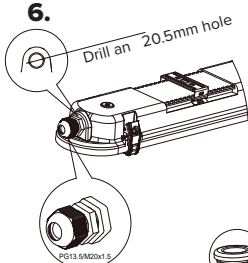

Wiring through side cable entry

Drill a 20.5 mm hole at the designated location on the left or right side. Insert the provided M20 cable gland to maintain the IP rating during cable entry.

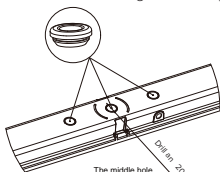

Wiring through rear cable entry

Drill a 20.5 mm hole at the designated location on the top side. Insert the provided rubber cable gland to maintain the IP rating during cable entry.

7.

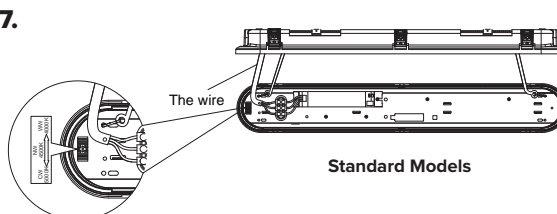

Standard Models

Use a 3x1.5 mm² cable. Connect the wires to the terminals labeled L (Live), N (Neutral), and E (Earth) on the Standard Model.

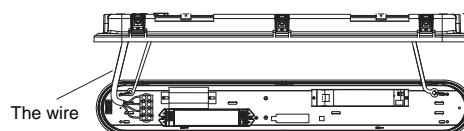

Emergency Models

Use a 4x1.5 mm² cable. Connect the wires to the terminals labeled N (Neutral), SA (Switched Active), UA (Unswitched Active), and E (Earth) on the Emergency Model.

HANECO LED BATTEN INSTALLATION GUIDE

DURA^{G2}

Thanks for choosing our DURA^{G2} weatherproof batten products.
We strongly recommend that you read this manual carefully before installation.

8. SENSOR INSTALLATION (OPTIONAL)

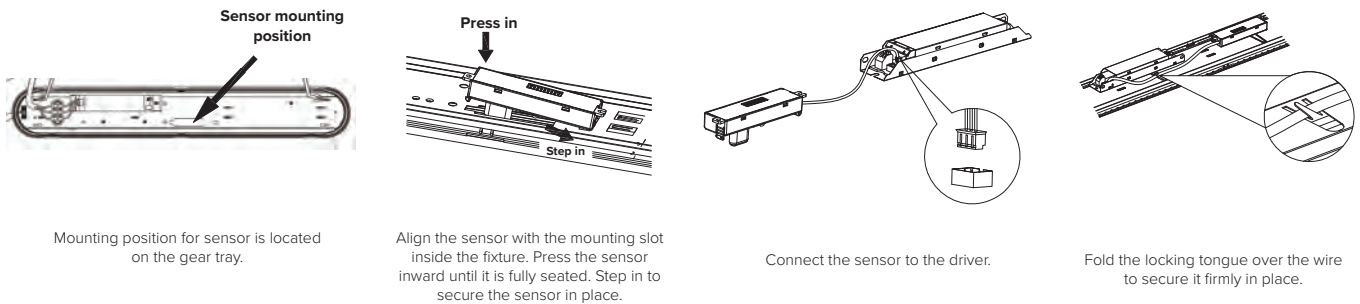

9.

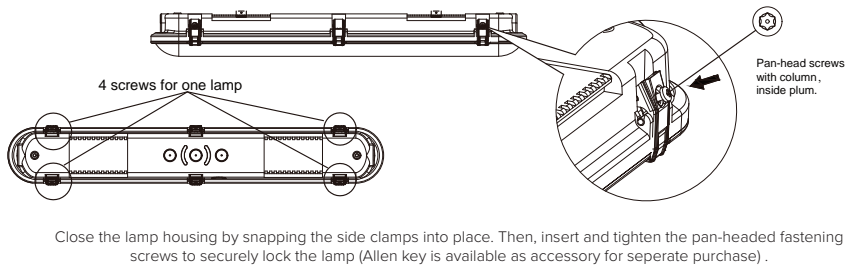

10.

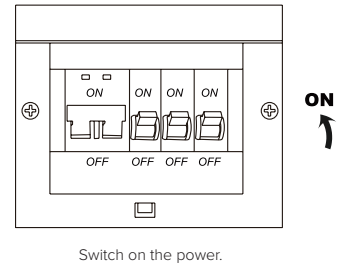

Accessory information

Haneco offers a range of accessories to suit your installation needs. The following accessories are compatible with and available for the DURA^{G2} range.

Product Code	Description
TSSKIT-1M	Batten suspension kit - 1 meter
TSSKIT-2M	Batten suspension kit - 2meter
DURA-SENKIT-G2	Plug-in microwave motion sensor kit
DURA-HEXKEY	Allen key for Hex Socket cap screws