

Installation Instructions

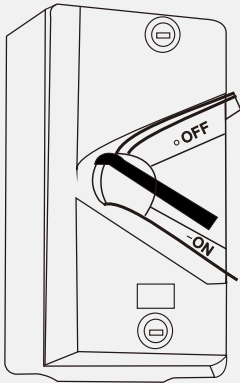

Weatherproof Isolators

Product Code:

ISLS20A1P
ISLS35A1P
ISLS63A1P
ISLS20A3P
ISLS35A3P
ISLS63A3P

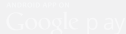

Important Safety Information

- This product must be installed by a licensed electrician in accordance with all the requirements of AS/NZS 3000 (current edition) and other relevant Standards and Regulations.
- Electricity MUST be disconnected prior to installation. Failure to do so may result in serious injury and or loss of life.
- Complies to Australian Standards AS 60947.3:2023 with AS/NZS 60947.1:2021 (IEC 60947-3:2020 (Ed.4.0) MOD with IEC 60947.1:2020 (Ed. 6.0) MOD
- No user serviceable parts inside

FEATURES

- High ingress protection - IP66 rated
- Pad lockable in off position for added protection (suits 6mm shackle)
- UV stabilised to avoid discolouring
- Multiple mounting facilities
- Switches mounted on base for stability
- Terminals suit 4 x 2.5mm² cable
- Earth and Neutral cables secured reliably with two screws on both line and load sides
- Colour coded terminals for ease of identification
- Entries: 4 x 25mm threaded. 2 x 25mm entry on rear
- 2 x Plain Reducer 25/20 included
- Covers secured and removed with two fast-action retention screws
- 5 year warranty

TECHNICAL SPECIFICATIONS

Operating Temp: -20°C to 85°C

Supply: 220-240V AC 50Hz

Rated Voltage: 500V

Rated Impulse withstand voltage suitable for isolation: 4kV

Rated Duty: Uninterrupted Duty

Rated Short-time withstand current and duration: 1.2kA/1s

Rated Short-Circuit Making Capacity: 2kA

DIMENSIONS

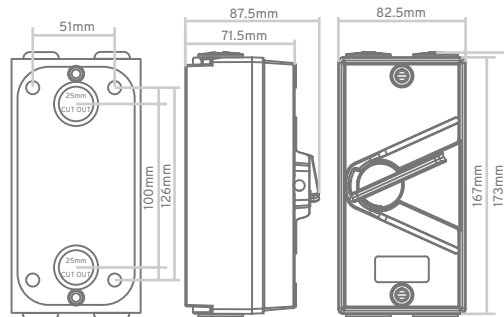

CONNECTION DIAGRAM

- After the base is fixed, please fit the caps over screw holes to ensure waterproof rating
- Weatherproof sealant needs to be used on cable entrance holes used at the top of the Isolator

