

SENTRY

PRODUCT CODE: SENTRY12W06-TRI

Specifications

Voltage/Frequency	240vac, 50Hz
IP Rating	IP66
IK Rating	IK10
Power Consumption	12W
Dimensions (LxWxH)	675x96x116mm
Weight	1.6Kg
Material	Polycarbonate
Lumens	> 900lm
Operating Humidity %	10% to 95% RH, non condensing
Operating Temperature °C	-15 to +50°
Storage Humidity %	10% to 95% RH, non condensing
CRI	>80
Colour Temp	2700K 4000K 6500K
Lifespan (L70)	50,000hrs
Dimming	Non dimmable

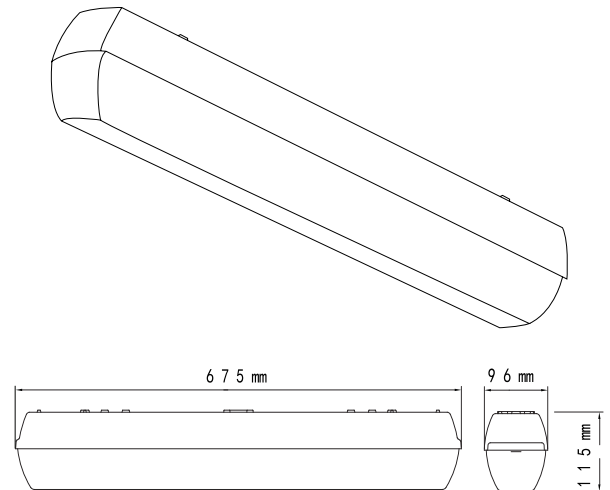

Installation Requirements

- This equipment must only be installed and serviced by an appropriately licensed electrical person.
- All wiring and installation of this product must adhere to local and national wiring rules. e.g.: AS/NZS 3000 Electrical Instructions.
- Check whether the product has been damaged during transport. Do not operate/install any product which appears damaged in any way. Return the complete product to the place of purchase for inspection, repair or replacement.
- Take care not to pull any electrical wires during unpacking as this may damage the connection.
- Isolate the electrical supply before doing any work on this equipment.

Installation Instructions

1. Remove all packaging material from the product.
2. Mark hole centres for fixing. Drill holes suitable to accept fixing method.
3. Secure and install the product using appropriate fasteners. Set the colour temperature switch.
4. Safely terminate wiring to maintain IP rating. Pay particular attention to any markings.
5. Check seals, gaskets and cable gland operation before operating the product.

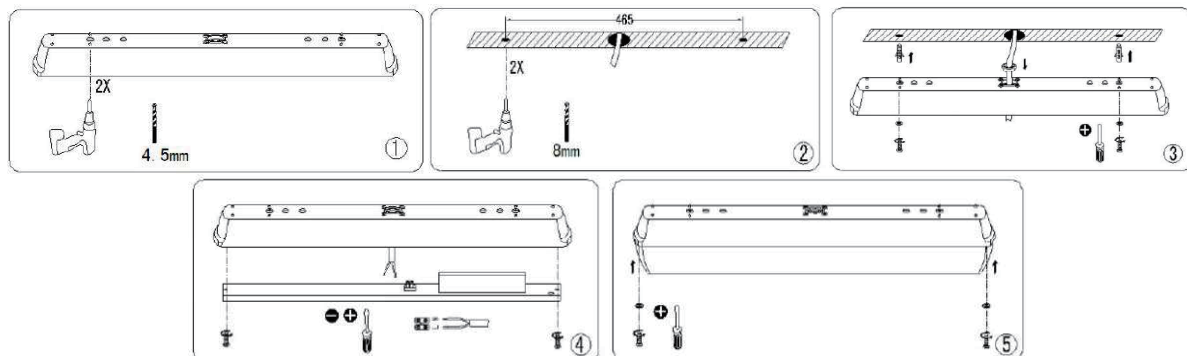

WARNING

The batten must be installed by professional electrician.
 Switch power off when wiring the LED batten.
 Ensure product is installed in a well ventilated area.
 Ensure input voltage conforms to the voltage range of product.
 Ensure wires are securely connected.
 Before switching on, ensure that all the wiring is correct.
 The warranty is void if product is not installed according to the instructions.