

TERRALUX SP 1200W

Power Meets Precision.

Engineered for sports fields and large outdoor spaces, Terralux combines high-output performance with tailored asymmetric optics and rugged IP66/IK08 protection. Its extruded aluminium heat sink ensures reliable thermal management, while built-in 10kV surge and over-temperature protection deliver long-term durability. Available in 600W and 1200W models, it's ideal for stadiums, courts, airports, industrial zones, and public areas.

Product Code: TLSP12-A1740

SAP Code: 4001317

Power	Lumen Output	CCT	CRI	Beam Angle	Adjustment Agnle	IK Rating	IP Rating	Warranty
1200 W	Up to 180,000 lm	4000 K	> 70	A1 Narrow Beam	0° - 90°	IK08	IP66	7 years

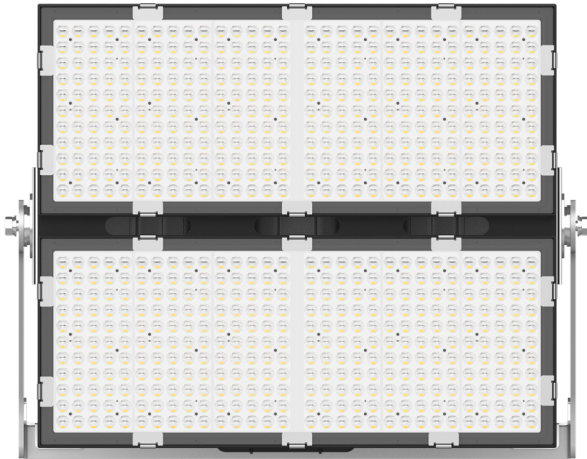

Key advantages:

- Designed in Australia for Australian conditions
- Precision asymmetric distribution
- Operating temperature up to 50°C
- Electronic DALI 2 driver, can be installed on the trunnion arm with optional mounting brackets or remotely up to 300m
- Durable aluminium body
- Reliability with 7 years warranty
- Supplied with bird spikes as standard
- All exposed cabling has bird proof conduit

Applications:



ELECTRICAL

Input Voltage	220–415Vac, 50/60Hz
Power Factor	> 0.90
Electrical Classification	Class I
Surge Protection	10kV

OTHERS

Body Material	Aluminium
Diffuser Material	Tempered Glass
Operating Ambient Temp.	-20 to 40°C
Cable Requirement	5c+E

DIMENSIONS (mm)

600 x 514 x 170 (not including trunnion)

WEIGHT (kg)

25 kg (without driver)

Aerodynamic Resistance Windage (m²)

Tilt Angle (°)	Terralux Raw EPA (m²)
0	0.102
5	0.128
10	0.154
15	0.178
20	0.201
25	0.223
30	0.243

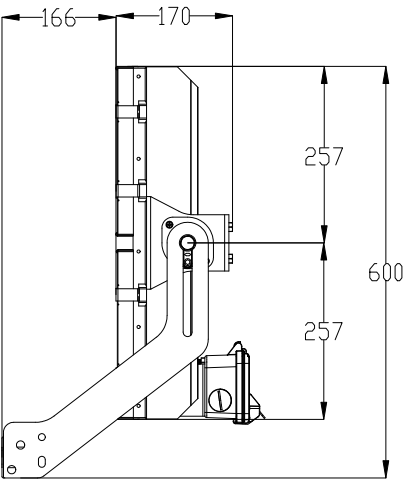
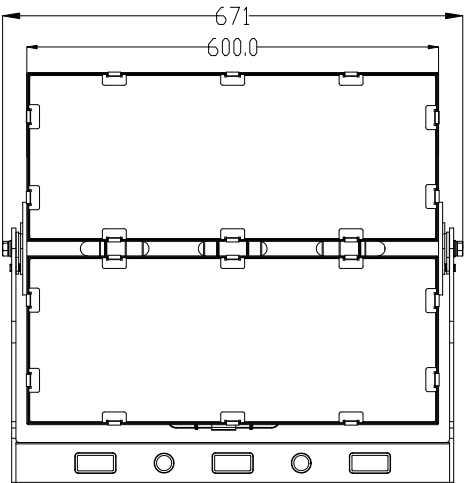

Electronic Control Gear

Product Code: TLSP12-EDRVR
SAP Code: 4001319

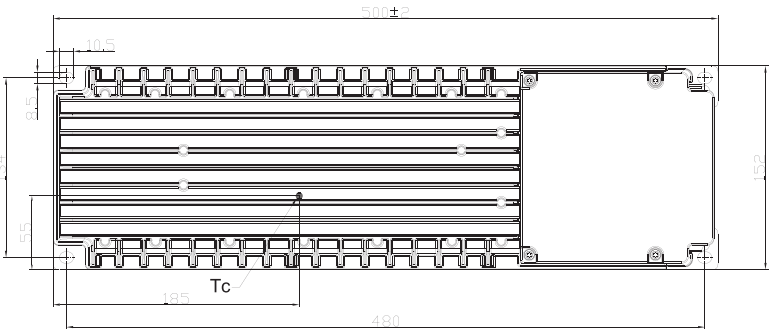
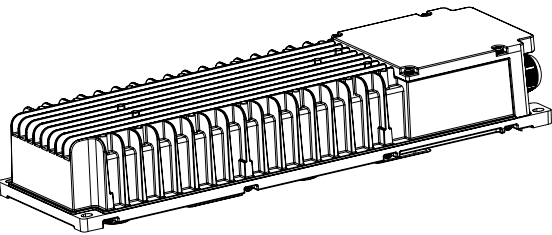

Cable Sizing - DC Output

Distance from floodlight (m)	Cable Size
< 100	1.5mm²
> 100, <300	2.5mm²

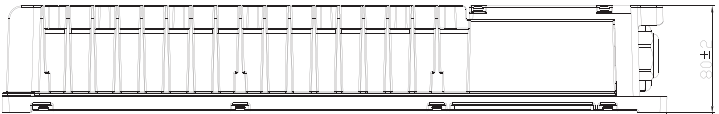
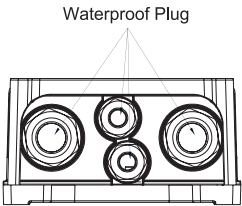

Product description	Wattage (KW)	Control	IP Rating	Voltage	Weight	Dimension (mm)
1200W Non-Isolated 2 Channels Programmable IP66 Driver	1.2	DALI-2	IP66	180-528V	6.5 KG	500 × 152 × 80