

Living Enhanced 



KASTA 240V Solutions

POWERING INNOVATION

SWITCHES, POWERPOINTS & ISOLATORS



Edgy™ Series

Hesperus™ Series

ATMOS™ Series



Edgy™ Series

SWITCH INTERFACES AND POWERPOINTS





KASTA delivers simple, effective control solutions designed to enhance everyday living.

KASTA combines Australian design and engineering to deliver a state-of-the-art collection of control interfaces and devices, ensuring seamless connectivity and superior performance.

Solutions



Residential



Multi-Residential



Serviced Apartments



Hotels



Offices



Commercial



Industrial

Simple installation

- ✓ Suitable for retro-fitting or new builds
- ✓ Common industry standard footprint for ease of retro fit.
- ✓ Large terminals and combination head screws for fast fit-offs







Edgy™ Series features a slim, clean design with modern bevelled edges that easily blends into today's modern environments, décor and lifestyles.

There are various products available within the range including smart control options as well as traditional 240V switches and powerpoints for a consistent look and versatile control options.

HIGHLY
POLISHED
FINISH

7.8MM
SLIM PLATE
DEPTH

EDGY™ SERIES

Unison™ Traditional 240V Switches



Gloss White



Matte Black



Make it all match with Unison™

The Edgy™ Series of Unison™ switches and powerpoints feature an identical slim design with the same modern, bevelled edge to complete the look.

See Pages 20 - 22 for full list of configuration options for Edgy



EDGY™ SERIES

Unison™ Traditional 240V Powerpoints and Data/Communication Plates



Edgy™ Unison™: behind the scenes

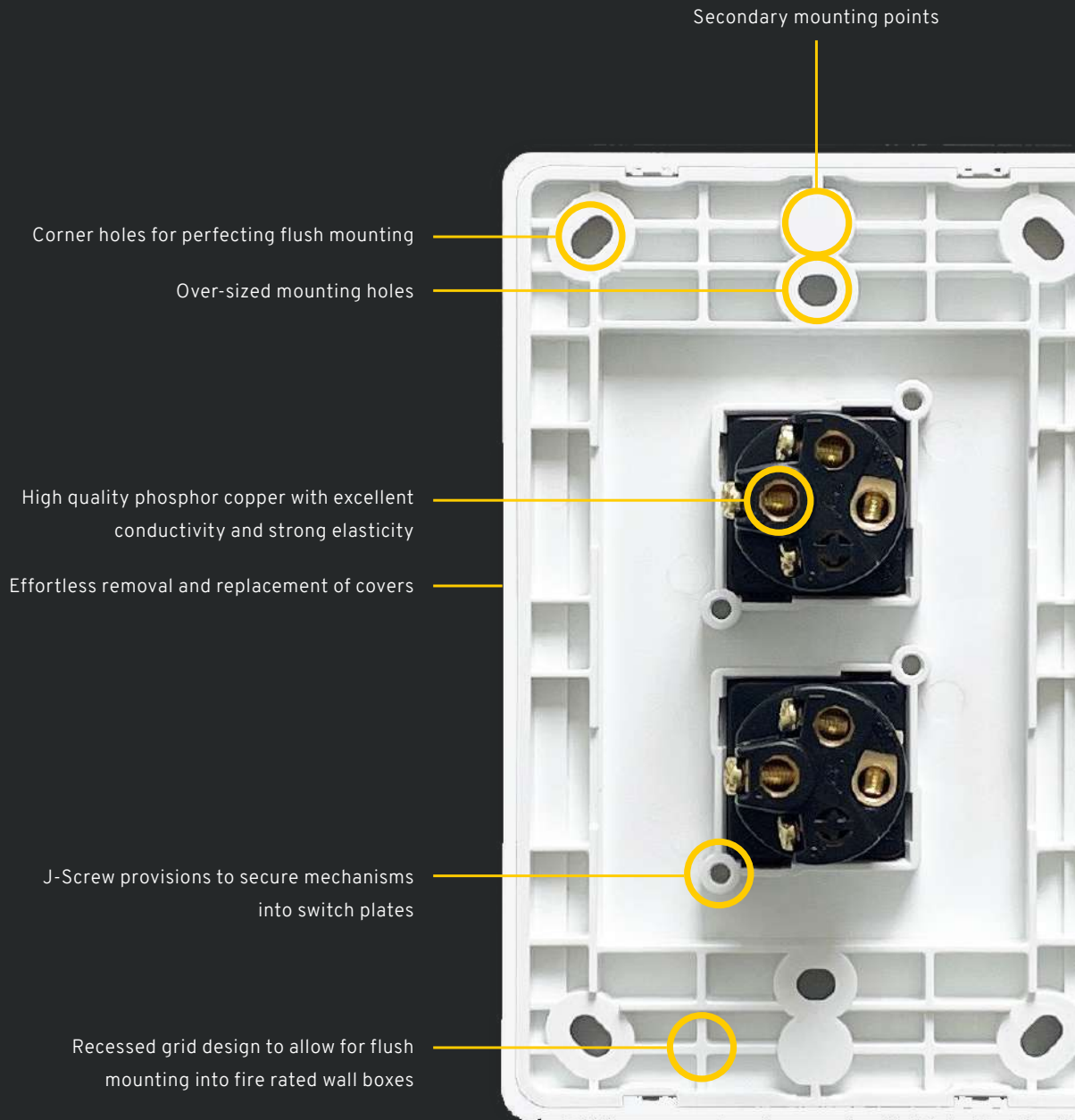

Quality componentry and clever design for an enhanced installation experience

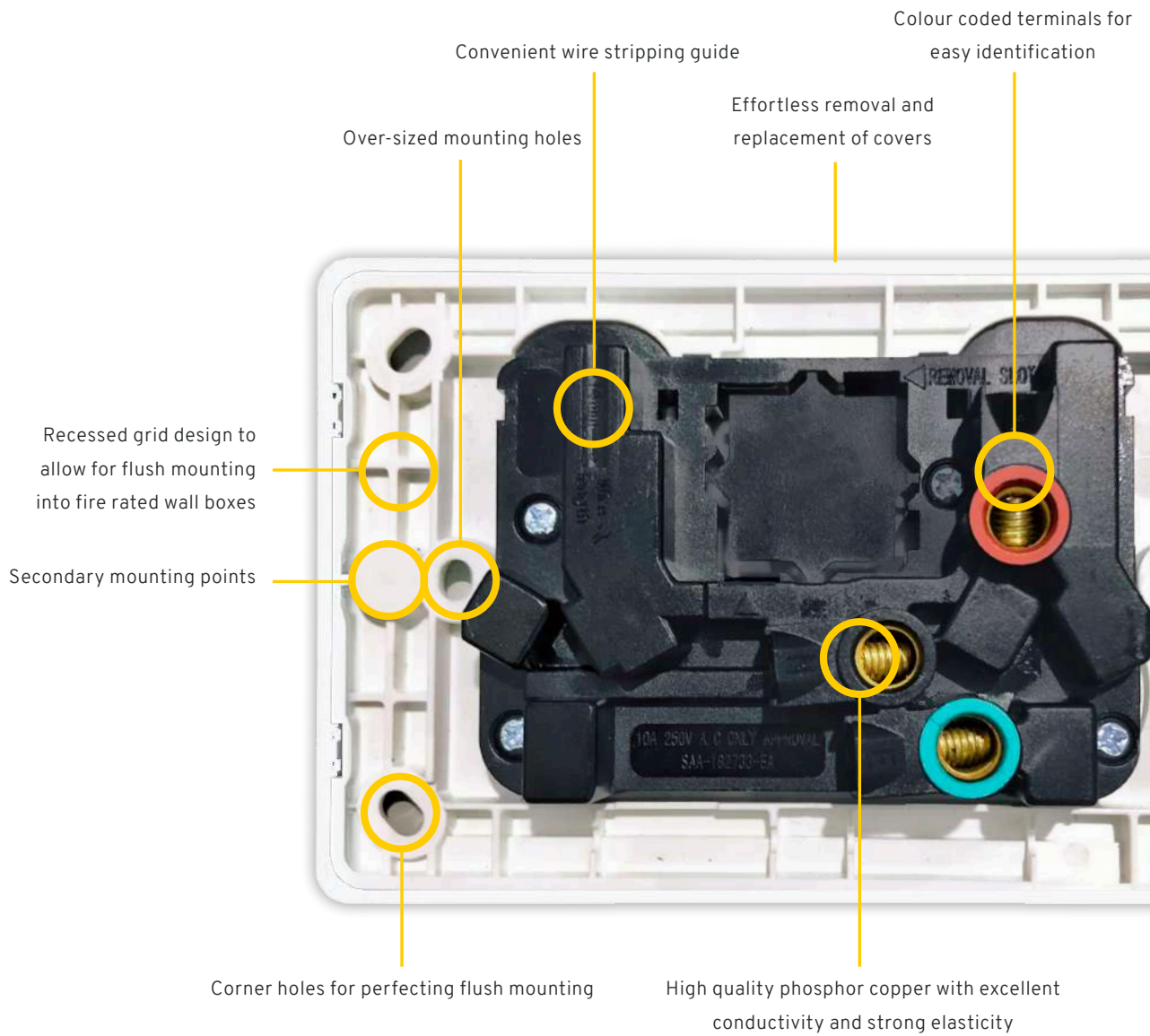

A complementary range of 240V powerpoints to suit a wide variety of power outlet and data input requirements.



EDGY™ Unison Powerpoints

/ Gloss White & Matte Black

Choose from single or double configurations, 10A or 15A power supply, horizontal or vertical orientations, a variety of extra aperture options, and white or matte black plate colours.



COMMON SPECIFICATIONS

Dimensions	121 x 80 x 44mm
Plate Depth	7.8mm
Power Supply	220-240V a.c. 50Hz
Operating Ambient Temperature	-20 to 40°C
IP Rating	IP20
Current Rating	10 / 15A
Energy Monitor	0.01A to 10A
Terminal Size	16mm ² (accommodates 4x2.5mm ² cables)
Terminal Screw Type	Combination Flat / Philips Head Screws
Mounting Points	84mm / 100mm and Corners
Mounting Screw Type	Combination Flat / Philips Head Screws
Plate Colour (Finish)	White (Gloss) / Matte Black
Housing Material	Polycarbonate
Standards Complied	CoS SAA 183650, AS/NZS 60669.2.1, AS/NZS 60669.1, AS/NZS CISPR 15, AS/NZS 4268

UNISON POWERPOINTS, GLOSS WHITE - 10A, 250V A.C.

DESCRIPTION		PRODUCT CODE	SAP CODE
1 POWERPOINT	HORIZONTAL	EG1PPH-WH	5000123
1 POWERPOINT, W/ EXTRA SWITCH	HORIZONTAL	EG1PPHX-WH	5000300
2 POWERPOINTS	HORIZONTAL	EG2PPH-WH	5000124
1 POWERPOINT, W/ EXTRA SWITCH	HORIZONTAL	EG2PPHX-WH	5000126
1 POWERPOINT, W/ EXTRA APERTURE	HORIZONTAL	EG2PPHX-WH	5000125
2 POWERPOINTS W/ USB A+C	HORIZONTAL	EG2PPHU2AC-WH	7500146
1 POWERPOINT	VERTICAL	EG1PPV-WH	5000313
2 POWERPOINTS	VERTICAL	EG2PPV-WH	5000315

UNISON POWERPOINTS, MATTE BLACK -10A, 250V A.C.

DESCRIPTION		PRODUCT CODE	SAP CODE
1 POWERPOINT	HORIZONTAL	EG1PPH-MBK	5000299
1 POWERPOINT, W/ EXTRA BUTTON	HORIZONTAL	EG1PPHX-MBK	5000301
2 POWERPOINTS	HORIZONTAL	EG2PPH-MBK	5000304
1 POWERPOINT, W/ EXTRA BUTTON	HORIZONTAL	EG2PPHX-MBK	5000308
1 POWERPOINT, W/ EXTRA APERTURE	HORIZONTAL	EG2PPHX-MBK	5000307
2 POWERPOINTS W/ USB A+C	HORIZONTAL	EG2PPHU2AC-MBK	7500147
1 POWERPOINT	VERTICAL	EG1PPV-MBK	5000314
2 POWERPOINTS	VERTICAL	EG2PPV-MBK	5000316

UNISON POWERPOINTS, GLOSS WHITE - 15A, 250V A.C.

DESCRIPTION		PRODUCT CODE	SAP CODE
1 POWERPOINT	HORIZONTAL	EG1PP15H-WH	5000302

UNISON POWERPOINTS, MATTE BLACK -15A, 250V A.C.

DESCRIPTION		PRODUCT CODE	SAP CODE
1 POWERPOINT	HORIZONTAL	EG1PP15H-MBK	5000303

Edgy™ Unison

/ Assembled Switches

1 to 6-button vertical assembled switches.



COMMON SPECIFICATIONS

Dimensions	120 x 80 x 27mm
Plate Depth	7.8mm
Power Supply	220-240V a.c.
IP Rating	IP20
Current Rating	10A
Operating Ambient Temperature	-20 to 40°C
Terminal Size	4.1mm bore (accommodates 4x1.5mm ² cables)
Terminal Screw Type	Flat Terminal Screw
Mounting Points	84mm / 103mm and Corners
Mounting Screw Type	Combination Flat / Philips Head Screws
Plate Colour (Finish)	White (Gloss) / Matte Black
Housing Material	Polycarbonate
Standards Complied	AS/NZS 3100, AS/NZS 3133

UNISON SWITCHES, GLOSS WHITE - 10AX, 250V A.C.

DESCRIPTION	PRODUCT CODE	SAP CODE
1-GANG, VERTICAL	EG1ASV-WH	5000117
2-GANG, VERTICAL	EG2ASV-WH	5000118
3-GANG, VERTICAL	EG3ASV-WH	5000119
4-GANG, VERTICAL	EG4ASV-WH	5000120
5-GANG, VERTICAL	EG5ASV-WH	5000121
6-GANG, VERTICAL	EG6ASV-WH	5000122

UNISON SWITCHES, MATTE BLACK - 10AX, 250V A.C.

DESCRIPTION	PRODUCT CODE	SAP CODE
1-GANG, VERTICAL	EG1ASV-MBK	5000273
2-GANG, VERTICAL	EG2ASV-MBK	5000274
3-GANG, VERTICAL	EG3ASV-MBK	5000275
4-GANG, VERTICAL	EG4ASV-MBK	5000276
5-GANG, VERTICAL	EG5ASV-MBK	5000277
6-GANG, VERTICAL	EG6ASV-MBK	5000278

Edgy™ Unison

/ Assembled Switches

1 to 6-button horizontal assembled switches.

UNISON SWITCHES, GLOSS WHITE - 10AX, 250V A.C.

DESCRIPTION	PRODUCT CODE	SAP CODE
1-GANG, HORIZONTAL	EG1ASH-WH	5000287
2-GANG, HORIZONTAL	EG2ASH-WH	5000289
3-GANG, HORIZONTAL	EG3ASH-WH	5000291
4-GANG, HORIZONTAL	EG4ASH-WH	5000293
5-GANG, HORIZONTAL	EG5ASH-WH	5000295
6-GANG, HORIZONTAL	EG6ASH-WH	5000297

UNISON SWITCHES, MATTE BLACK - 10AX, 250V A.C.

DESCRIPTION	PRODUCT CODE	SAP CODE
1-GANG, HORIZONTAL	EG1ASH-MBK	5000288
2-GANG, HORIZONTAL	EG2ASH-MBK	5000290
3-GANG, HORIZONTAL	EG3ASH-MBK	5000292
4-GANG, HORIZONTAL	EG4ASH-MBK	5000294
5-GANG, HORIZONTAL	EG5ASH-MBK	5000296
6-GANG, HORIZONTAL	EG6ASH-MBK	5000298



Edgy™ Unison

/ Grid Plates and Covers

1 to 6-button grid plates and covers for use with KASTA mechanisms.

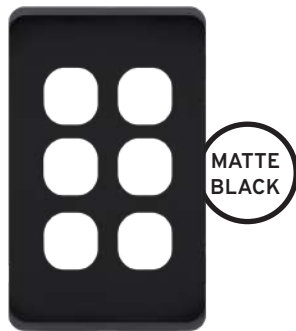

UNISON EDGY GRID PLATES & COVERS, GLOSS WHITE

DESCRIPTION	PRODUCT CODE	SAP CODE
BLANK COVER	EG1V-WH	5000279
1-BUTTON GRID	EG1SVH-WH	5000111
2-BUTTON GRID	EG2SVH-WH	5000112
3-BUTTON GRID	EG3SVH-WH	5000113
4-BUTTON GRID	EG4SVH-WH	5000114
5-BUTTON GRID	EG5SVH-WH	5000115
6-BUTTON GRID	EG6SVH-WH	5000116

UNISON EDGY GRID PLATES & COVERS, MATTE BLACK

DESCRIPTION	PRODUCT CODE	SAP CODE
BLANK COVER	EG1V-MBK	5000280
1-BUTTON GRID	EG1SVH-MBK	5000281
2-BUTTON GRID	EG2SVH-MBK	5000282
3-BUTTON GRID	EG3SVH-MBK	5000283
4-BUTTON GRID	EG4SVH-MBK	5000284
5-BUTTON GRID	EG5SVH-MBK	5000285
6-BUTTON GRID	EG6SVH-MBK	5000286

A wide range of Pictogram Button Caps are available to choose from to suit KASTA smart mechanisms that fit into Edgy™ Series grid plate and covers.

COMMON SPECIFICATIONS

Dimensions	120 x 78 x 7.8mm
Plate Depth	7.8mm
IP Rating	IP20
Terminal Size	4.1mm bore (accommodates 4x1.5mm ² cables)
Terminal Screw Type	Flat Terminal Screw
Mounting Points	84mm / 103mm and Corners
Mounting Screw Type	Combination Flat / Philips Head Screws
Plate Colour (Finish)	White (Gloss) / Matte Black
Housing Material	Polycarbonate

Choose from a wide range of KASTA mechanisms to suit your Edgy™ Grid Plates and Covers:

MECHANISMS

Unison™ Mechanisms

/ Push Button ON/OFF

/ Push Button Cap



PRODUCT CODE	SAP CODE
MEPBLS1440-WH	5000196



PRODUCT CODE	SAP CODE
KMCAP-CT-MBK	5000466

/ Rocker Switches



Gloss White



Matte Black



DESCRIPTION	COLOUR	PRODUCT CODE	SAP CODE
SINGLE POLE 1/2 WAY 10AX 250V	GLOSS WHITE	MR10-WH	5000127
	MATTE BLACK	MR10-MBK	5000490
DOUBLE POLE 1 WAY 10AX 250V	GLOSS WHITE	MRD10-WH	5000128
	MATTE BLACK	MRD10-MBK	5000469
DOUBLE POLE 1 WAY 35A 250V	GLOSS WHITE	MRD35-WH	5000129
	MATTE BLACK	MRD35-MBK	5000470
DOUBLE POLE 1 WAY 35A 250V MARKED 'HOB'	GLOSS WHITE	MRD35HOB-WH	5000130
	MATTE BLACK	MRD35HOB-MBK	5000491
SINGLE POLE 1 WAY 10AX 250V MARKED 'PRESS'	GLOSS WHITE	MRMPRESS-WH	5000131
	MATTE BLACK	MRMPRESS-MBK	5000471
INTERMEDIATE, 10A, 250V	GLOSS WHITE	MRINT10-WH	5000487
	MATTE BLACK	MRINT10-MBK	5000488

Unison™ Mechanisms
/ Data & Communications

○ Gloss White ● Matte Black



DESCRIPTION	COLOUR	PRODUCT CODE	SAP CODE
HDMI	GLOSS WHITE	MHDMI-WH	5000337
	MATTE BLACK	MHDMI-MBK	5000492
RJ45, CAT6	GLOSS WHITE	MRJ45C6-WH	5000254
	MATTE BLACK	MRJ45C6-MBK	5000493
RJ11, TEL	GLOSS WHITE	MRJ11-WH	5000342
	MATTE BLACK	MRJ11-MBK	5000494
TV, Coaxial	GLOSS WHITE	MTVC-WH	5000344
	MATTE BLACK	MTVC-MBK	5000495
TV, F Type	GLOSS WHITE	MTVF-WH	5000346
	MATTE BLACK	MTVF-MBK	5000496



MU2AC-WHBKMBK
USB Type A+C
Including White, and
Matte Black caps

DESCRIPTION	COLOUR	PRODUCT CODE	SAP CODE
USB Mechanism	WHITE, MATTE BLACK	MU2AC-WHBKMBK	5000432



Living Enhanced 

Hesperus™ Series

UNISON™ 240V SWITCHES AND POWERPOINTS



Choose from a wide range of KASTA mechanisms
to suit your HESPERUS™ Grid Plates and Covers.

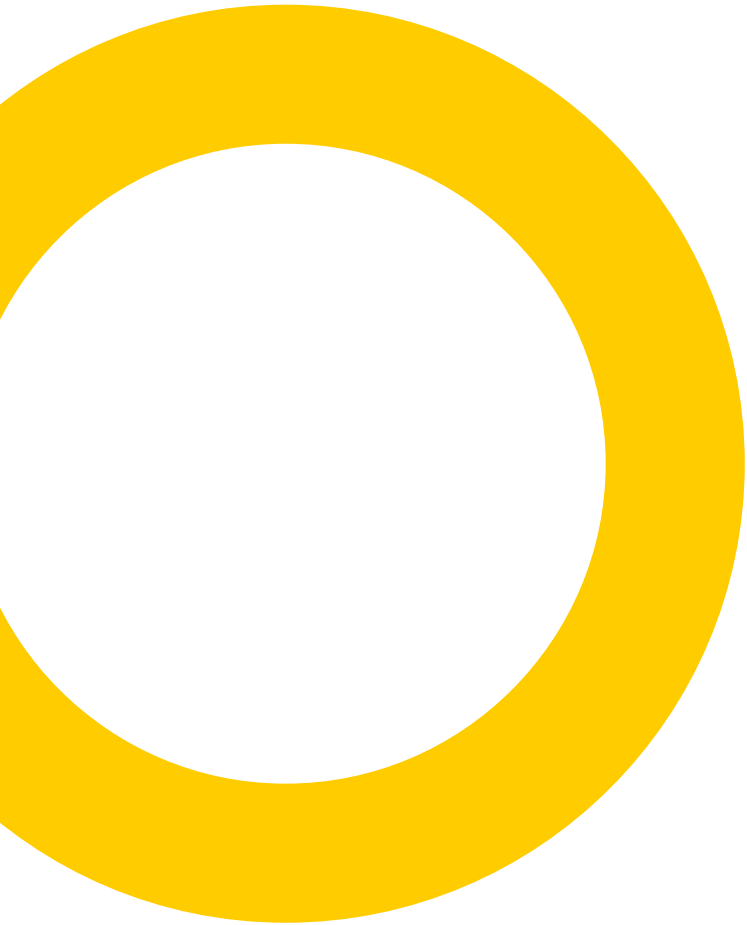

Inspirational **design**

KASTA Technologies has created a series of products that embody the essence of design, attention to detail, cutting-edge technology and innovation.

The Hesperus™ Series of Unison™ 240V switches and powerpoints offer a contemporary design that was created to be adaptable to suit changing interior design and aesthetic trends.



KEY COLLABORATOR:
Piero Quintiliani - PQ Design Studio, Pisa, Milano ITALY







Instantly enhance



Unison™ switches

The Hesperus™ Series of Unison™ switches feature a modern, slim design with a luxury glass-look finish. These switches will instantly upgrade interior spaces and have the option of being simply retrofit to existing wall mount accessories.



Unison™ switches

Choice of 6 configurations

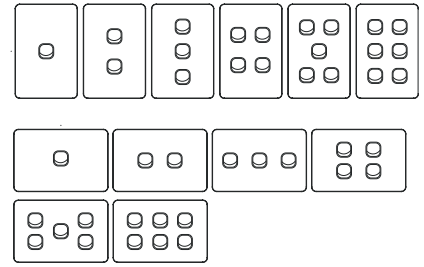

HIGHLY
POLISHED
FINISH

SCRATCH
PROTECTIVE
FILM

9.8MM
SLIM PLATE
DEPTH

5 YEAR
WARRANTY



Gloss White



Gloss Black

Form and function comes together to deliver

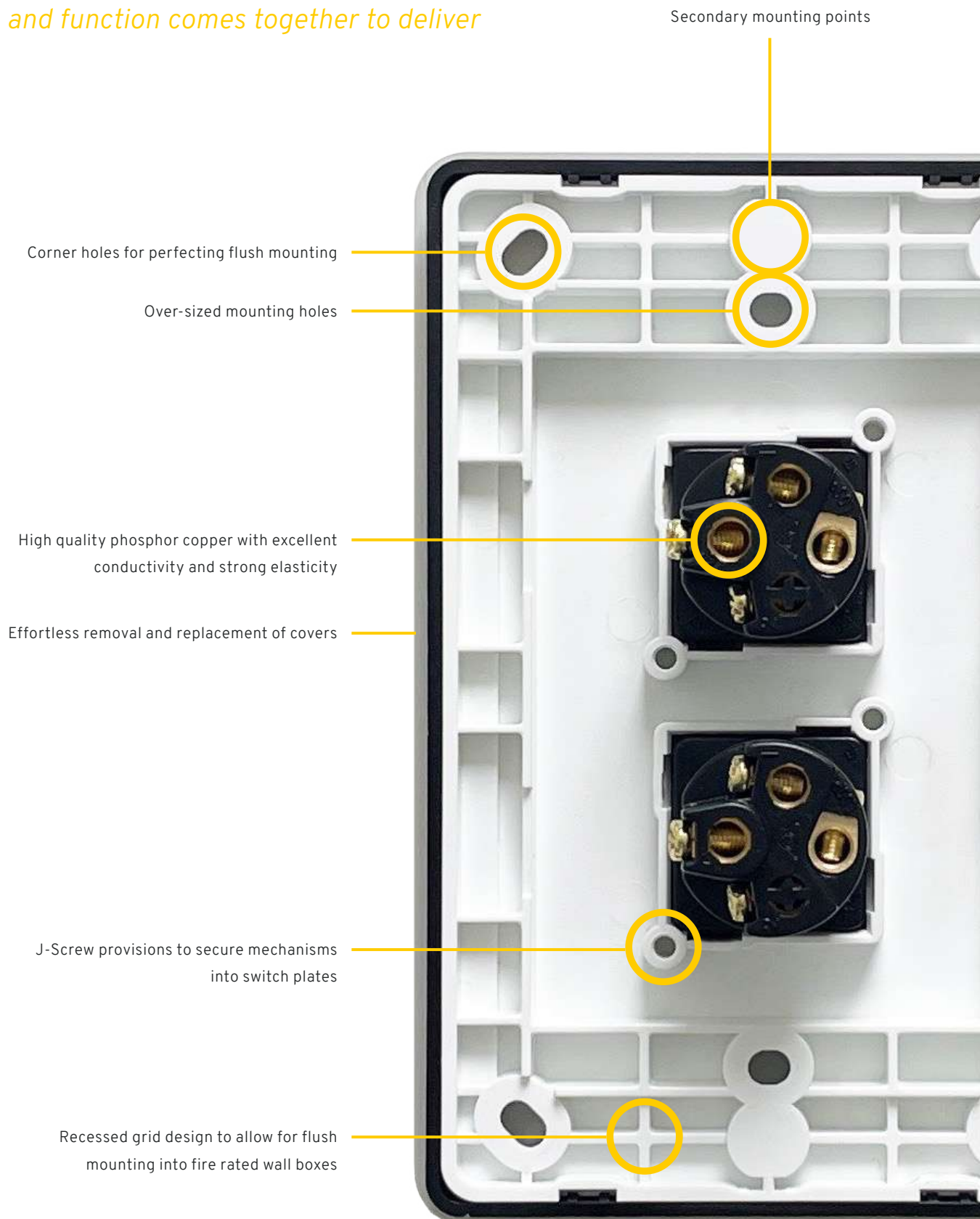



Unison™ powerpoints

The Hesperus™ Series of Unison™ 10A powerpoints also feature a modern, slim design with a luxury glass-look finish that's completed with complementary gloss-finish sockets. These powerpoints are offered in a range of configurations and include many design features to enhance aesthetics, ease of installation and ensure safety.

Unison™ powerpoints

Choice of 5 configurations



Premium powerpoints that offer convenient

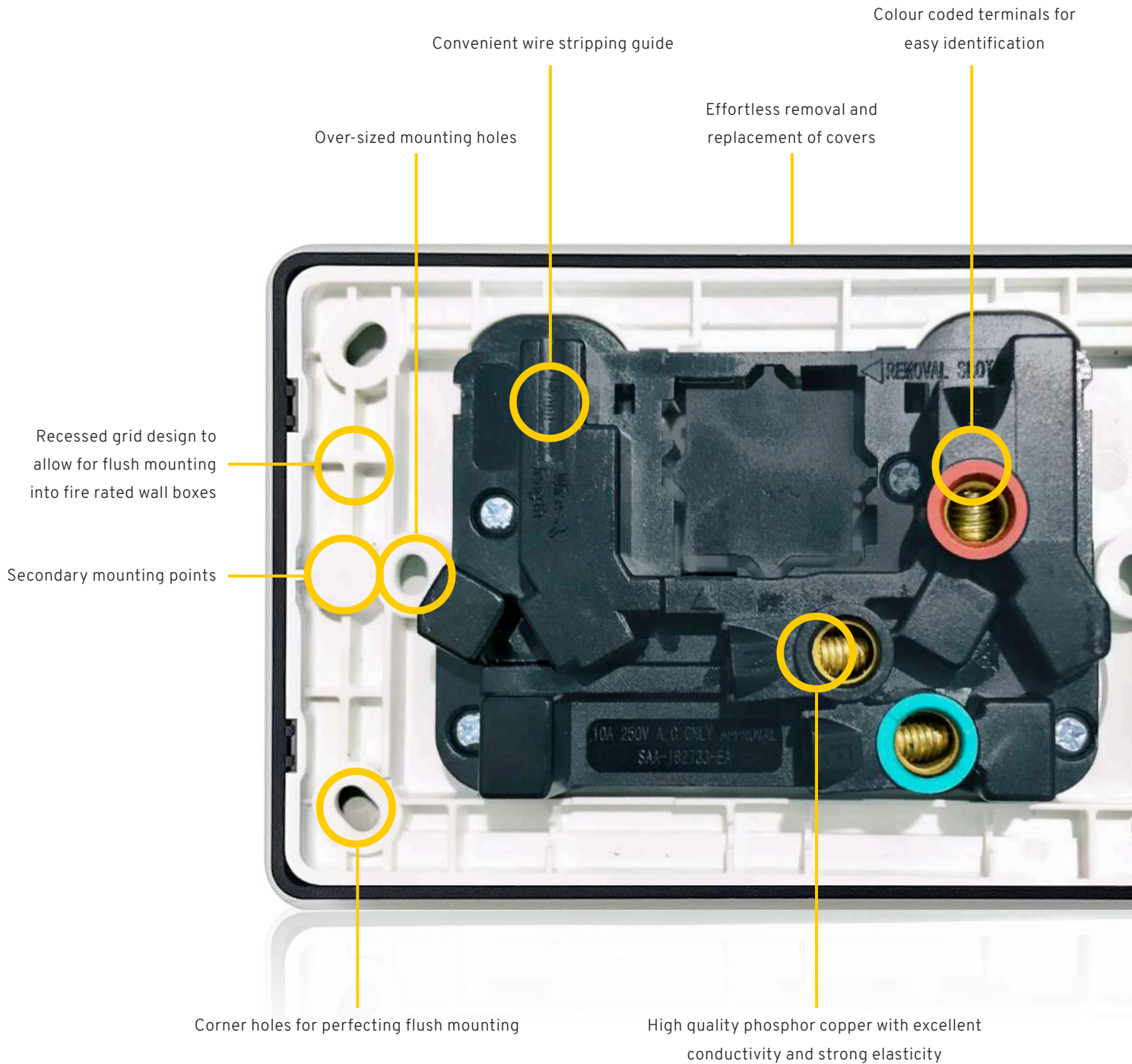

*Add **push buttons** or*





Unison™ plate solutions

KASTA offers a range of mechanisms that easily install into our Hesperus™ series of luxurious wall plates.



Unison™ wall plates

includes grid plate and cover

HIGHLY
POLISHED
FINISH

Suitable for all KASTA push
button mechanisms

Suitable for all KASTA data and
communications mechanisms

9.8MM
SLIM PLATE
DEPTH

SCRATCH
PROTECTIVE
FILM

5 YEAR
WARRANTY

Unison™ mechanisms

Whether charging your mobile devices, connecting your tv aerial or simply changing from traditional rocker switching to push button interaction, we've made it simple to use Hesperus™ switch plates throughout the home.



Push button mechanisms with blue LED indicator, fits up to 6 Gang in the Hesperus™ Unison™ switch plate.



Specify Unison™

HESPERUS™ UNISON™ SWITCHES

/ Gloss White (10AX, 250a.c. Vertical)



H1ASV-WH



H2ASV-WH



H3ASV-WH



H4ASV-WH



H5ASV-WH



H6ASV-WH

/ Gloss Black (10AX, 250a.c. Vertical)



H1ASV-BK



H2ASV-BK



H3ASV-BK



H4ASV-BK



H5ASV-BK



H6ASV-BK

/ Gloss White (10AX, 250a.c. Horizontal)



H1ASH-WH



H2ASH-WH



H3ASH-WH



H4ASH-WH



H5ASH-WH



H6ASH-WH

/ Gloss Black (10AX, 250a.c. Horizontal)



H1ASH-BK



H2ASH-BK



H3ASH-BK



H4ASH-BK



H5ASH-BK



H6ASH-BK



Specify Unison™

Hesperus™ Unison

/ Powerpoints

A complementary range of 240V powerpoints to suit a wide variety of power outlet and data input requirements.

Choose from single or double configurations and horizontal or vertical orientations, a variety of extra aperture options, and white or black plate colours.



SPECIFICATIONS

Dimensions	121 x 80 x 44mm
Plate Depth	9.8mm
Power Supply	220-240V a.c. 50Hz
Operating Ambient Temperature	-20 to 40°C
IP Rating	IP20
Current Rating	10A
Terminal Size	16mm ² (accommodates 4x2.5mm ² cables)
Terminal Screw Type	Combination Flat / Philips Head Screws
Mounting Points	84mm / 100mm and Corners
Mounting Screw Type	Combination Flat / Philips Head Screws
Frame Colour (Finish)	Black (Gloss)
Plate Colour (Finish)	White / Black (Gloss)
Housing Material	Acrylic / Polycarbonate
Standards Complied	CoS SAA 183650, AS/NZS 60669.2.1, AS/NZS 60669.1, AS/NZS CISPR 15, AS/NZS 4268

PLATE COLOUR	PRODUCT TYPE	PRODUCT CODE	SAP CODE
White	Horizontal	H1PPH-WH	5000078
Black	Horizontal	H1PPH-BK	5000217
White	Horizontal	H2PPH-WH	5000219
Black	Horizontal	H2PPH-BK	5000220
White	Horizontal	H2PPHXA-WH	5000373
Black	Horizontal	H2PPHXA-BK	5000374
White	Horizontal	H2PPHX-WH	5000371
Black	Horizontal	H2PPHX-BK	5000372
White	Horizontal	H2PPHU2AC-WH	7500148
Black	Horizontal	H2PPHU2AC-BK	7500149

Hesperus™ Unison

/ Assembled Switches

1 to 6-button vertical assembled switches.

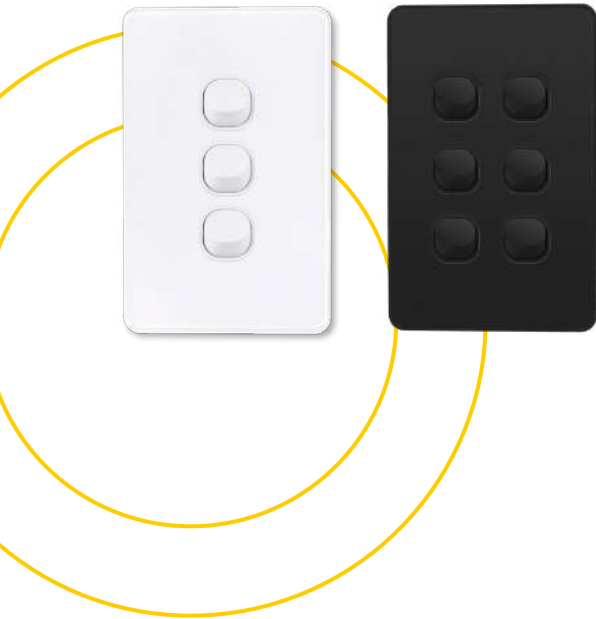

SPECIFICATIONS	
Dimensions	120 x 80 x 27.4mm
Plate Depth	9.8mm
Power Supply	220-240V a.c.
IP Rating	IP20
Current Rating	10A
Operating Ambient Temperature	-20 to 40°C
Terminal Size	4.1mm bore (accommodates 4x1.5mm ² cables)
Terminal Screw Type	Flat Terminal Screw
Mounting Points	84mm / 103mm and Corners
Mounting Screw Type	Combination Flat / Philips Head Screws
Frame Colour (Finish)	Black (Gloss)
Plate Colour (Finish)	White / Black (Gloss)
Housing Material	Acrylic / Polycarbonate
Standards Complied	AS/NZS 3100, AS/NZS 3133

PLATE COLOUR	PRODUCT TYPE	PRODUCT CODE	SAP CODE
White	Vertical	H1ASV-WH	5000198
Black	Vertical	H1ASV-BK	5000199
White	Vertical	H2ASV-WH	5000201
Black	Vertical	H2ASV-BK	5000202
White	Vertical	H3ASV-WH	5000204
Black	Vertical	H3ASV-BK	5000205
White	Vertical	H4ASV-WH	5000207
Black	Vertical	H4ASV-BK	5000208
White	Vertical	H5ASV-WH	5000210
Black	Vertical	H5ASV-BK	5000211
White	Vertical	H6ASV-WH	5000213
Black	Vertical	H6ASV-BK	5000214

SPECIFICATIONS	
Dimensions	120 x 80 x 27.4mm
Plate Depth	9.8mm
Power Supply	220-240V a.c.
IP Rating	IP20
Current Rating	10A
Operating Ambient Temperature	-20 to 40°C
Terminal Size	4.1mm bore (accommodates 4x1.5mm ² cables)
Terminal Screw Type	Flat Terminal Screw
Mounting Points	84mm / 103mm and Corners
Mounting Screw Type	Combination Flat / Philips Head Screws
Frame Colour (Finish)	Black (Gloss)
Plate Colour (Finish)	White / Black (Gloss)
Housing Material	Acrylic / Polycarbonate
Standards Complied	AS/NZS 3100, AS/NZS 3133

PLATE COLOUR	PRODUCT TYPE	PRODUCT CODE	SAP CODE
White	Horizontal	H1ASH-WH	7500133
Black	Horizontal	H1ASH-BK	7500134
White	Horizontal	H2ASH-WH	7500136
Black	Horizontal	H2ASH-BK	7500135
White	Horizontal	H3ASH-WH	7500138
Black	Horizontal	H3ASH-BK	7500137
White	Horizontal	H4ASH-WH	7500140
Black	Horizontal	H4ASH-BK	7500139
White	Horizontal	H5ASH-WH	7500142
Black	Horizontal	H5ASH-BK	7500141
White	Horizontal	H6ASH-WH	7500144
Black	Horizontal	H6ASH-BK	7500143

Hesperus™ Unison

/ Assembled Switches

1 to 6-button vertical assembled switches.



Hesperus™ Unison

/ Grid Plates and Covers

1 to 6-button grid plates and covers for use with KASTA mechanisms.



A wide range of Pictogram Button Caps are available to choose from to suit KASTA smart mechanisms that fit into Hesperus™ and grid plate and covers.

SPECIFICATIONS

Dimensions	120 x 80 x 9.8mm
Plate Depth	9.8mm
IP Rating	IP20
Terminal Size	4.1mm bore (accommodates 4x1.5mm ² cables)
Terminal Screw Type	Flat Terminal Screw
Mounting Points	84mm / 103mm and Corners
Mounting Screw Type	Combination Flat / Phillips Head Screws
Frame Colour (Finish)	Black (Gloss)
Plate Colour (Finish)	White / Black (Gloss)
Housing Material	Acrylic / Polycarbonate

PLATE COLOUR	PRODUCT CODE	SAP CODE
White	H1SVH-WH	5000359
Black	H1SVH-BK	5000365
White	H2SVH-WH	5000360
Black	H2SVH-BK	5000366
White	H3SVH-WH	5000361
Black	H3SVH-BK	5000367
White	H4SVH-WH	5000362
Black	H4SVH-BK	5000368
White	H5SVH-WH	5000363
Black	H5SVH-BK	5000369
White	H6SVH-WH	5000364
Black	H6SVH-BK	5000370

HESPERUS™ UNISON™ SWITCHES GRID PLATE & COVERS

/ Gloss White (Vertical)



/ Gloss Black (Vertical)

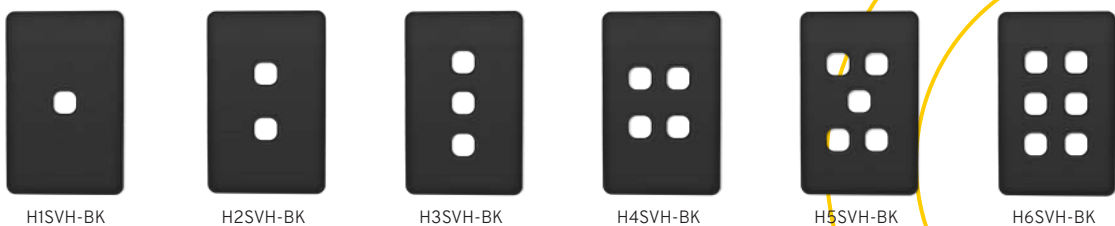

Choose from a wide range of KASTA mechanisms
to suit your HESPERUS™ Grid Plates and Covers.



Unison™ Mechanisms

DATA & COMMUNICATIONS

/ DATA MECHANISM RJ45 CAT6 (White / Black)



MRJ45C6-WH

MRJ45C6-BK

/ TEL MECHANISM RJ11 (White / Black)



MRJ11-WH

MRJ11-BK

/ TV MECHANISM COAXIAL (White / Black)



MTVC-WH

MTVC-BK

/ TV MECHANISM F TYPE (White / Black)



MTVF-WH

MTVF-BK

/ USB CHARGER MODULE, TYPE A+C, OUTPUT 2.4A
(Including White, Black and Matte Black caps)



MU2AC-WHBKMBK

/ HDMI 2.0 MECHANISM (White / Black)



MHDMI-WH

MHDMI-BK

DESCRIPTION	COLOUR	PRODUCT CODE	SAP CODE
RJ45, CAT6	GLOSS WHITE	MRJ45C6-WH	5000254
	GLOSS BLACK	MRJ45C6-BK	4500583
RJ11, TEL	GLOSS WHITE	MRJ11-WH	5000342
	GLOSS BLACK	MRJ11-BK	4500584
TV, Coaxial	GLOSS WHITE	MTVC-WH	5000344
	GLOSS BLACK	MTVC-BK	4500585
TV, F Type	GLOSS WHITE	MTVF-WH	5000346
	GLOSS BLACK	MTVF-BK	4500586
USB Mechanism	WHITE,BLACK,MATTE BLACK	MU2AC-WHBKMBK	5000432
HDMI	GLOSS WHITE	MHDMI-WH	5000337
	GLOSS BLACK	MHDMI-BK	4500582





ATMOS™ Series

POWERPOINTS, SWITCH INTERFACES AND ISOLATORS



ATMOS™ Series

POWERPOINTS, SWITCH INTERFACES AND ISOLATORS

Simple installation

- ✓ Suitable for retro-fitting or new builds
- ✓ Common industry standard footprint for ease of retro fit.
- ✓ Multiple knock-outs for flexible cable entry points
- ✓ Large terminals and combination head screws for fast fit-offs

Weatherproof Powerpoints

Discover the versatility and durability of our Weatherproof Powerpoint Range, designed to withstand demanding environments while ensuring safety and style for both residential and commercial applications.

Key features include:

Versatile Configurations: Choose from single, single square, double, or double with an extra switch, tailored to your needs.

Exceptional Protection: Rated IP54, eliminating the need for additional plastic covers, making it perfect for “ZONE 2” areas like pools, wet areas, and ponds, as per AS/NZS3000.

Enhanced Safety: Features sealed safety shutters and UV-stabilised materials to prevent discoloration and maintain durability over time.

Effortless Installation: Includes multiple mounting options, colour-coded terminals for easy identification, and back mounting boxes with 20mm and 25mm plain entries, supporting various installation locations.

Seamless Design: Matches the styling of the Atmos range of weatherproof switches, providing a cohesive look across all installations.



Residential



Multi-Residential



Commercial



Industrial



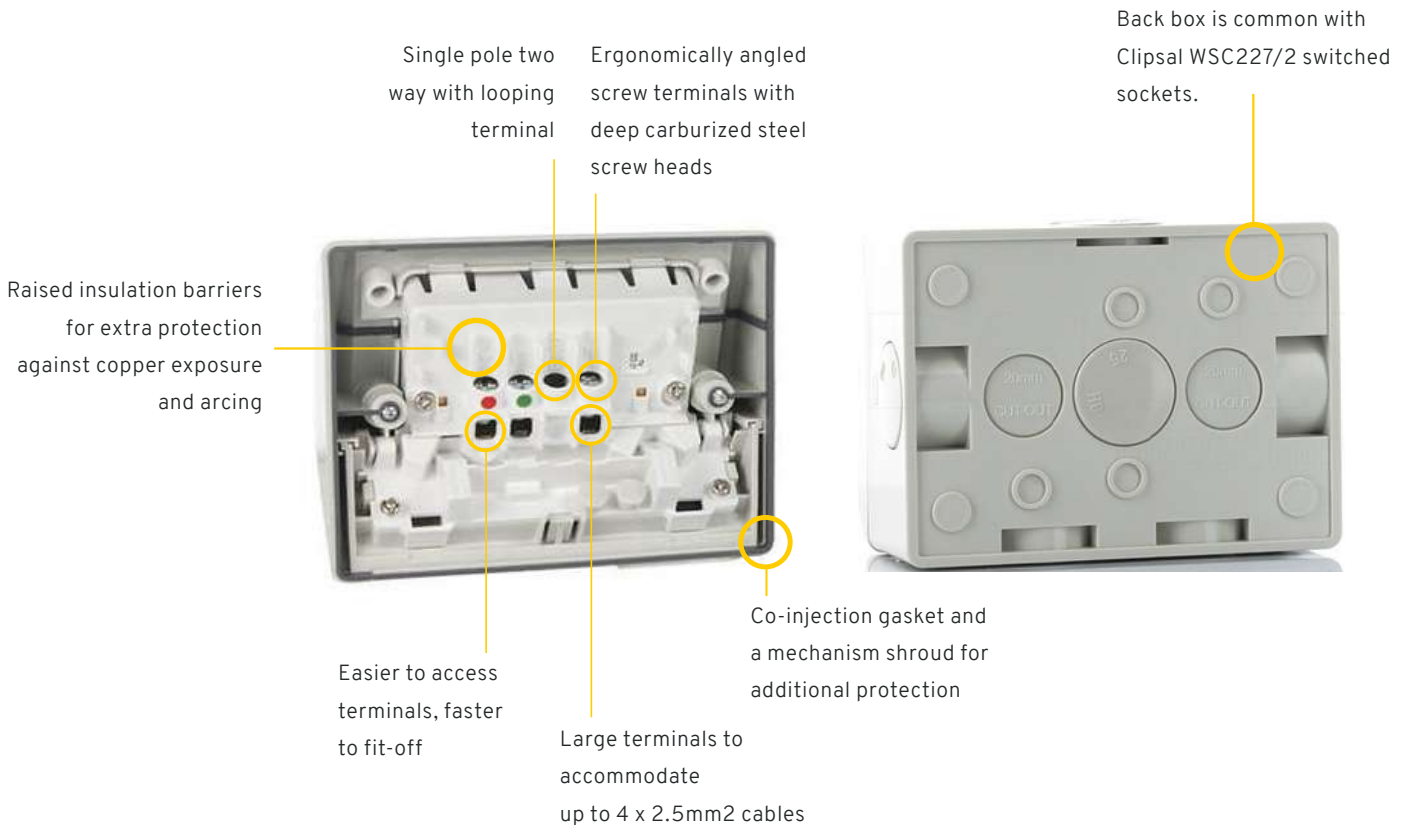
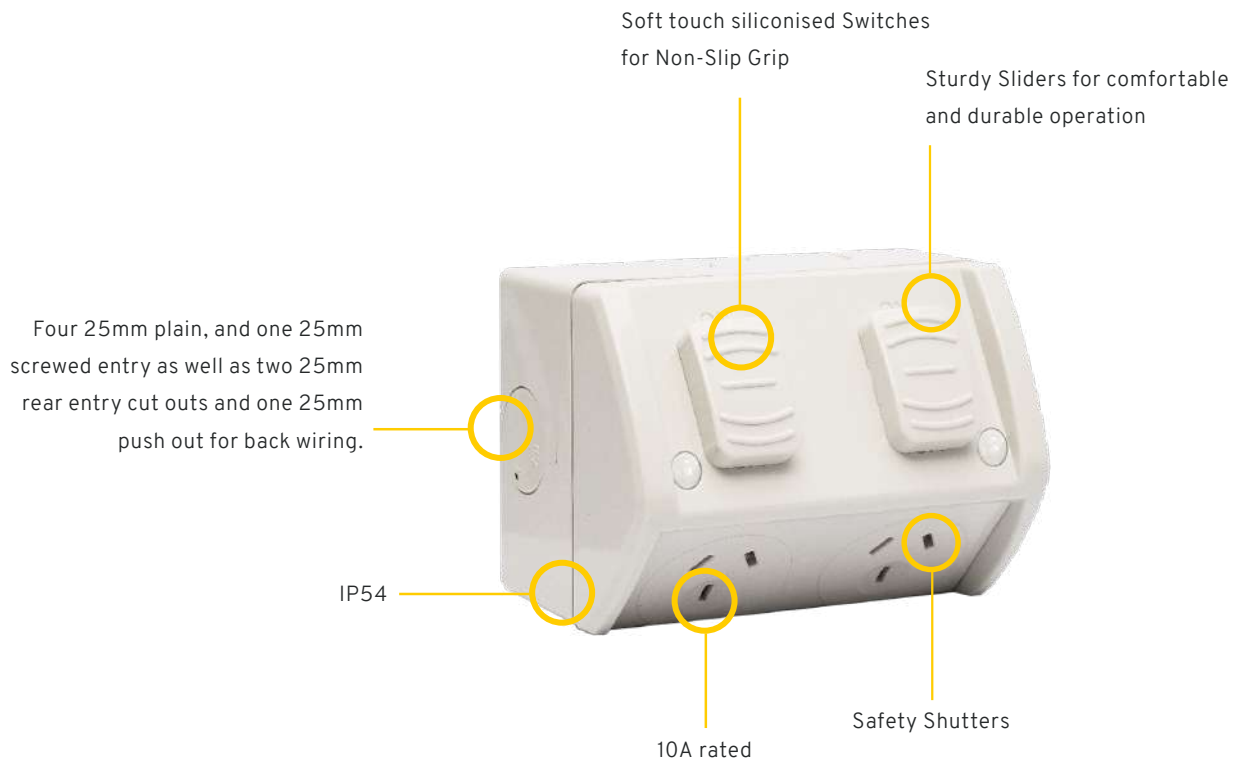

UNISON™ Powerpoints

Unison Atmos Weatherproof Powerpoint
/ Single, Square, 10A 250V a.c., IP54, Grey



ATPP1S-GY
SAP CODE: 5000250

Unison Atmos Weatherproof Powerpoint
/ Single, Rectangular, 10A 250V a.c., IP54, Grey



ATPP1-GY
SAP CODE: 5000251

Unison Atmos Weatherproof Powerpoint
/ Double, Rectangular, 10A 250V a.c., IP54, Grey



ATPP2N-GY
SAP CODE: 5000252

Unison Atmos Weatherproof Powerpoint
/ Double, Rectangular, 10A with Extra Switch, 250V a.c., IP54, Grey



ATPP2X-GY
SAP CODE: 5000253

Weatherproof Switch Range

Introducing our Weatherproof Switch Range, designed for reliability and durability in both residential and commercial environments. Rated at 16A 250V~, these switches are engineered to withstand tough conditions while maintaining exceptional performance and style.

Key features include:

Versatile Options: Available in single and double switch configurations with a heavy-duty mechanism and secure screw fittings.

Durable Construction: Made from UV-stabilised polycarbonate to prevent discolouration and ensure longevity in outdoor conditions.

Enhanced Protection: Featuring an IP66 rating, these switches provide superior resistance to water, dust, and other harmful elements, making them perfect for outdoor and challenging environments such as gardens, carports, workshops, and building exteriors.

Practical Design: Includes back mounting boxes with 20mm and 25mm plain entries to accommodate various installation requirements and terminals that support looping to other devices or side-by-side installations.

Seamless Aesthetic: Styled to match the Atmos range of weatherproof powerpoints, ensuring a cohesive look across your installations.

Whether for damp, dusty, or exterior spaces, this range delivers the ultimate combination of functionality, durability, and style.



Residential



Multi-Residential



Commercial



Industrial



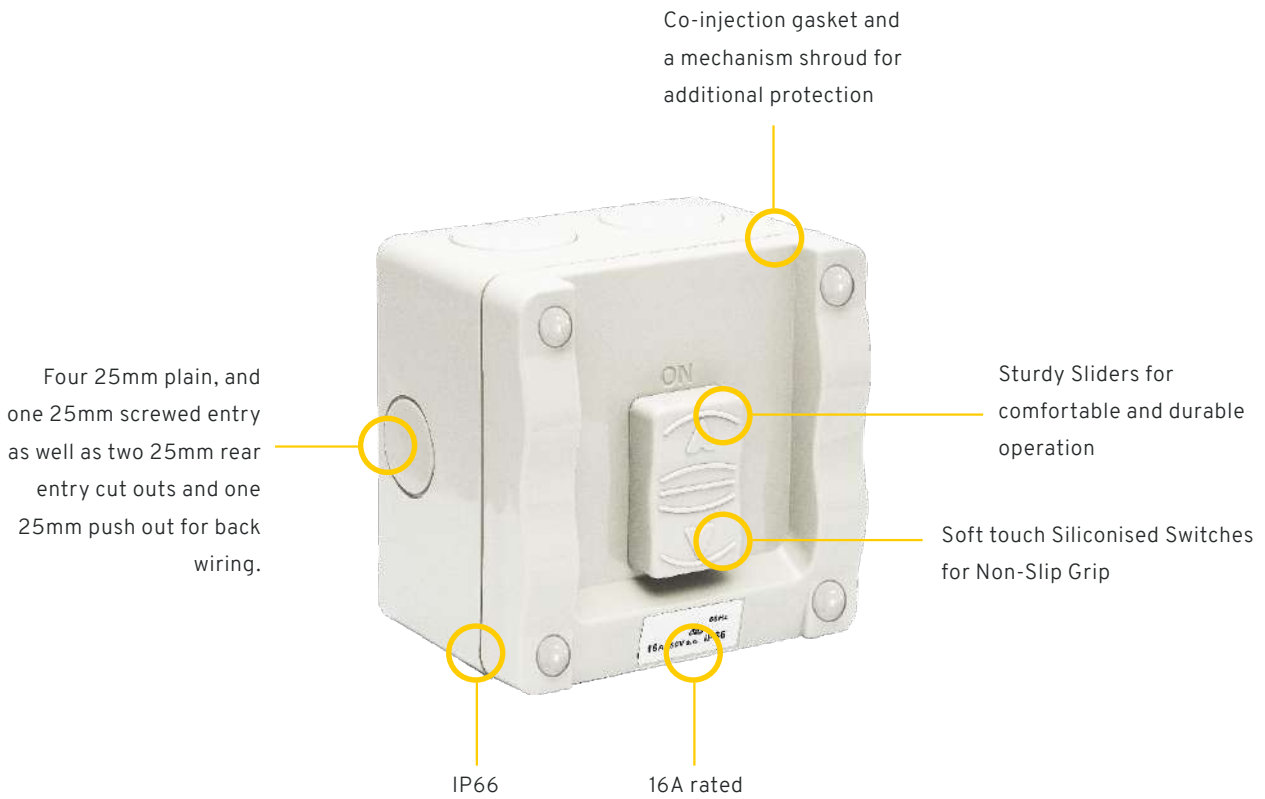
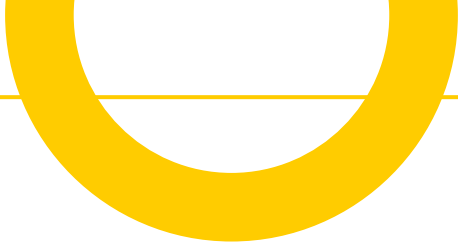

Back box is common with Clipsal WSC227/2 switched sockets.

Ergonomically angled screw terminals with deep carburized steel screw heads

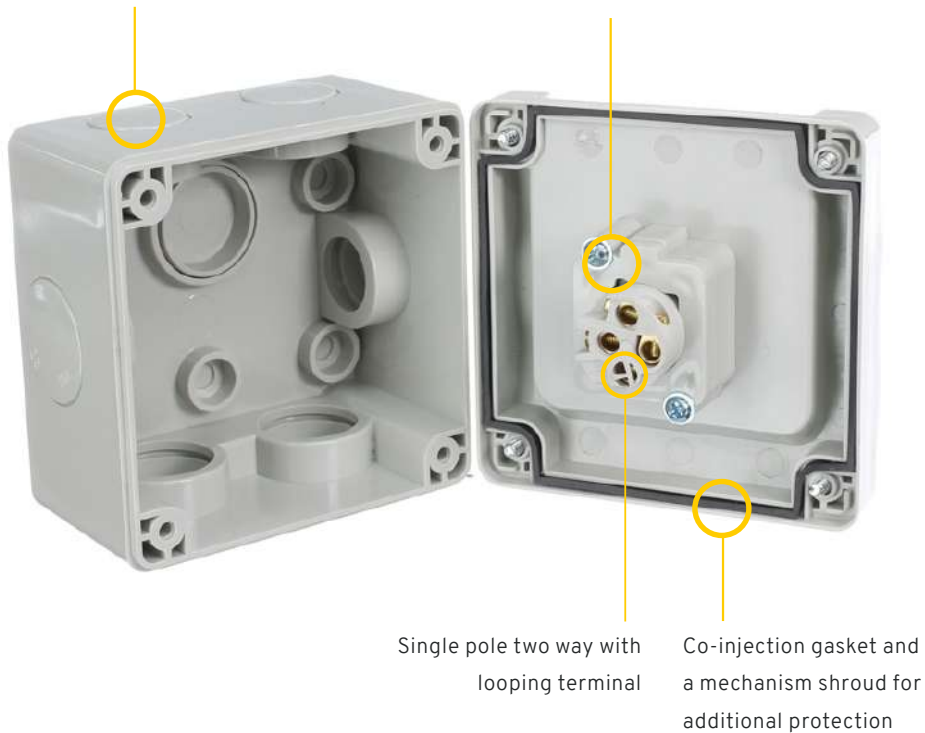

UNISON™ Switches

Unison Atmos Weatherproof Switch

/ 1 Gang, 16A, 250V a.c., IP66, Grey



ATS116-GY
SAP CODE: 5000329

Unison Atmos Weatherproof Switch

/ 2 Gang, 16A, 250V a.c., IP66, Grey



ATS116/2-GY
SAP CODE: 5000330

High-Performance Weatherproof Isolators

Engineered for industrial and demanding applications, the Weatherproof Isolator Range delivers top-tier performance and reliability with robust construction and enhanced safety features.

Key features include:

Superior Protection: With a high IP66 rating, these isolators guard against water, dust, and other harsh elements, ensuring dependable operation in challenging environments.

Enhanced Security: Pad-lockable in the off position (suits 6mm shackle) for added safety during maintenance or downtime.

Durable and Reliable: UV-stabilised materials prevent discoloration, and switches are mounted on a stable base for long-term durability.

Simplified Installation: Equipped with multiple mounting facilities, color-coded terminals, and entries including 4 x 25mm threaded and 2 x plain reducers (25/20), accommodating various installation needs.

User-Friendly Design: Covers are secured with fast-action retention screws for quick access, while earth and neutral cables are firmly secured with two screws on both line and load sides.

Peace of Mind: Backed by a 5-year warranty, offering confidence in every installation.



Residential



Multi-Residential



Commercial



Industrial



Entries: 4 x 25mm threaded.
2 x 25mm entry on rear.



UNISON™ Isolators

Unison Atmos Weatherproof Isolator

/ 1 pole, Large, IP66, Grey, AC23

20A 250V a.c. M.100



ISLS20A1P
SAP CODE: 5000461

35 A 250V a.c. M.180



ISLS35A1P
SAP CODE: 5000462

63A 250V a.c. M.200



ISLS63A1P
SAP CODE: 5000463

Unison Atmos Weatherproof Isolator

/ 3 pole, Large, IP66, Grey, AC23

20A 250V a.c. M.100



ISLS20A3P
SAP CODE: 5000458

35 A 250V a.c. M.140



ISLS35A3P
SAP CODE: 5000459

63 A 250V a.c. M.200



ISLS63A3P
SAP CODE: 5000460

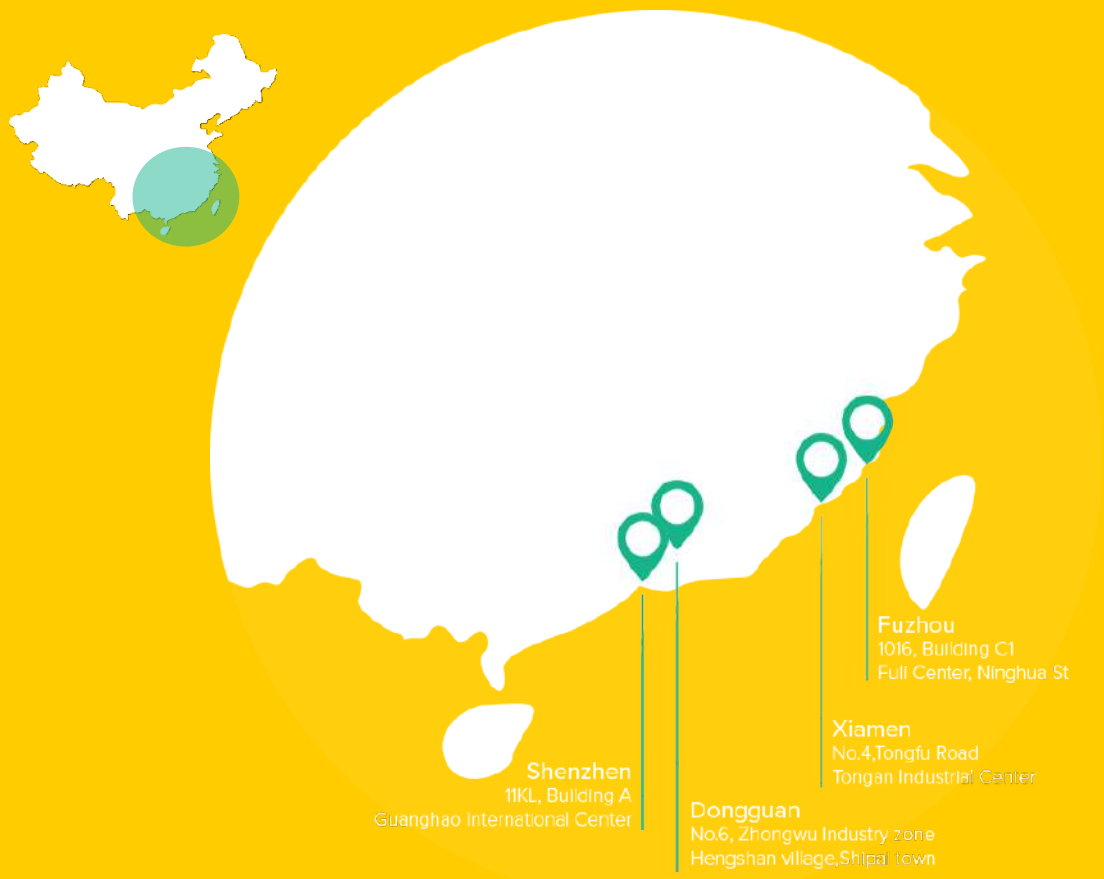

Shenzhen
11KL, Building A
Guanghao International Center

Fuzhou
1016, Building C1
Full Center, Ninghua St

Xiamen
No.4, Tongfu Road
Tongan Industrial Center

Dongguan
No.6, Zhongwu Industry zone
Hengshan village, Shipai town



Western Australia
Unit 4, 5 Spartan St
Jandakot, WA 6164
Ph: (08) 6169 1600

South Australia
262 Marion Rd
Netley, SA 5037
Ph: (08) 8297 6373

Victoria
26-28 Bando Rd
Springvale, VIC 3171
Ph: (03) 9008 6109

Tasmania
4 Linear Crt
Moonah, TAS 7009
Ph: (03) 6273 1855

Queensland
72 Crockford St
Northgate, QLD 4013
Ph: (07) 3123 5008

**New South Wales
and ACT**
157 Orchardleigh St
Old Gullford, NSW 2161
Ph: (02) 8999 1377

Contact **KASTA** 

02 9168 5900
kasta.com.au



Living **Enhanced** 